

Sanlixin Solenoid Valve

SMS 2/2-way Flange Connection Direct Acting Solenoid Valve-Normally Closed



Valve Selection List

Orifice mm	CV Factor	Operating pressure differential(kgf/cm ²)								Max. fluids Temp °C	Coil Type	Coil Class	Model Code Follows Voltage are 220VAC	Weight Kg	
		Min.	Max.						AC						DC
			Air Gas		Water Hot water Liquids		Light oil ≤20CST								
			AC	DC	AC	DC	AC	DC							
15	4.8	0	10	10	10	10	8	8	80	M	F	SMS1MF02N4F15	1.77		
15	4.8	0	10	10	10	10			130	M	F	SMS1MF02E4F15			
15	4.8	0	10	10	10	10	8	8	120	M	F	SMS1MF02V4F15			
20	7.6	0	10	10	10	10	8	8	80	M	F	SMS1MF02N4F20	1.97		
20	7.6	0	10	10	10	10			130	M	F	SMS1MF02E4F20			
20	7.6	0	10	10	10	10	8	8	120	M	F	SMS1MF02V4F20			
25	12	0	10	10	10	10	8	8	80	M	F	SMS1MF02N4F25	2.87		
25	12	0	10	10	10	10			130	M	F	SMS1MF02E4F25			
25	12	0	10	10	10	10	8	8	120	M	F	SMS1MF02V4F25			
32	24	0	10	10	10	10	8	8	80	M	F	SMS1MF02N4F32	4.4		
32	24	0	10	10	10	10			130	M	F	SMS1MF02E4F32			
32	24	0	10	10	10	10	8	8	120	M	F	SMS1MF02V4F32			
40	29	0	10	10	10	10	8	8	80	M	F	SMS1MF02N4F40	4.8		
40	29	0	10	10	10	10			130	M	F	SMS1MF02E4F40			
40	29	0	10	10	10	10	8	8	120	M	F	SMS1MF02V4F40			
50	48	0	10	10	10	10	8	8	80	M	F	SMS1MF02N4F50	7.8		
50	48	0	10	10	10	10			130	M	F	SMS1MF02E4F50			
50	48	0	10	10	10	10	8	8	120	M	F	SMS1MF02V4F50			

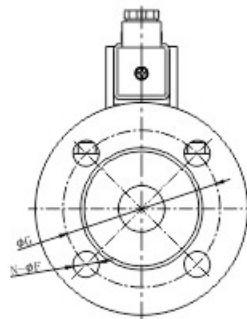
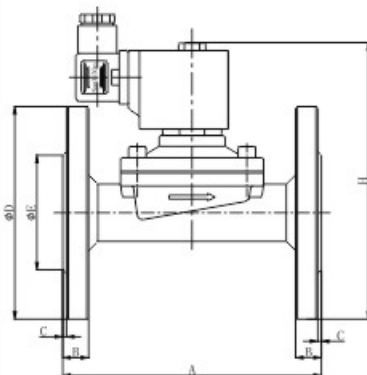

Model	A	B	C	D	E	N	F	G	H
SMS-15BF	106	12	2	95	45	4	14	65	135
SMS-20BF	106	12	2	105	56	4	14	75	138
SMS-25BF	140	14	2	115	62	4	14	85	150
SMS-32BF	152	15	2	135	76	4	18	100	173
SMS-40BF	152	15	2	145	84	4	18	110	183
SMS-50BF	195	16	2	160	98	4	18	125	197

SMS Series Coil parameters tables

Coils Model code	Voltage	Power consumption		DC (W)		Orifice mm
		Inrush	Holding	Inrush	Holding	
SM-3101	AC220V	78VA	4.5VA	350mA	20mA	Diaphragm Type Φ 15~Φ25
SM-3102	AC110V	72VA	5.0VA	660mA	45mA	
SM-3106	DC24V	50W	7.2W	2185mA	350mA	
SM-3104	AC24V	19VA	6.5VA	940mA	310mA	
SM-4101	AC220V	130VA	6VA	590mA	28mA	Direct Acting Type Φ2~Φ7.5
SM-4102	AC110V	95VA	8.0VA	900mA	75mA	
SM-4106	DC24V	50W	9W	2185mA	385mA	Diaphragm Type Φ32~Φ50
SM-4104	AC24V	19VA	7.0VA	930mA	360mA	